



Direct pressure automatic pinch valve

# NPV2 Series

- Working fluid: gas, water, sludge, powder
- Port size: 25 to 100 flange

For various fluids including gas, water, sludge, powder, etc.

- Completely closed structure, explosion proof type available
- Solid permissible
- Zero fluid resistance and no clogging
- Vibration/noise absorbing by rubber sleeve method
- Flange packing seal not required

## Specifications

Item	NPV2-25A-N	NPV2-40A-N	NPV2-50A-N	NPV2-65A-N	NPV2-80A-N	NPV2-100A-N
Working fluid	Gas, water, sludge, powder, non-corrosive fluids (refer to page 36 in the Introduction for details.)					
Connection	25 flange	40 flange	50 flange	65 flange	80 flange	100 flange
Port size mm	25	40	50	65	80	98
Cv flow factor	35	90	150	250	390	627
Working pressure range MPa	0.05 to 0.4					
Withstanding pressure MPa	1.0					
Operation air pressure MPa	0.2 to 0.3 larger than working pressure					
Fluid temperature °C	5 to 60					
Mounting attitude	Free					
Weight kg	4.6	5.9	7.1	9.7	11.8	16.8

## How to order

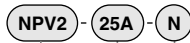

Model no.

Ⓐ Port size

Ⓑ Rubber sleeve material

Symbol	Descriptions
<b>Ⓐ</b> Port size	
<b>25A</b>	25 flange
<b>40A</b>	40 flange
<b>50A</b>	50 flange
<b>65A</b>	65 flange
<b>80A</b>	80 flange
<b>100A</b>	100 flange
<b>Ⓑ</b> Rubber sleeve material	
<b>N</b>	Chloroprene rubber

## Internal structure and parts list

## Dimensions

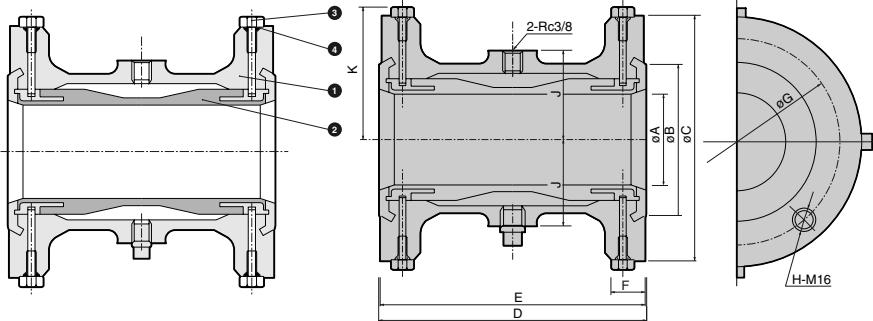

No.	Part name	Material
<b>1</b>	Body	FC250 Cast iron
<b>2</b>	Sleeve	CR Chloroprene rubber
<b>3</b>	Bolt	SUS304 Stainless steel
<b>4</b>	O ring	NBR Nitrile rubber

Model no.	A	B	C	D	E	F	G	H	J	K
<b>NPV2-25A</b>	25	63	125	161	160	18	90	4	43	66
<b>NPV2-40A</b>	40	75	140	161	160	20	105	4	49	75
<b>NPV2-50A</b>	50	90	155	171	170	20	120	4	55	82
<b>NPV2-65A</b>	65	109	175	186.5	185	22	140	4	63	94
<b>NPV2-80A</b>	80	121	185	231.5	230	22	150	8	78	97
<b>NPV2-100A</b>	98	147	210	286.5	285	24	175	8	89	111



Manual pinch valve

# HPV Series

- Working fluid: water, sludge, powder
- Port size: 25 to 100 flange

For various fluids including water, sludge, powder, etc.

- Completely closed structure
- Zero fluid resistance and no clogging
- Solid permissible
- Consumable part: Rubber sleeve only
- Flange packing seal not required

## Specifications

Item	HPV-25A	HPV-40A	HPV-50A	HPV-65A	HPV-80A	HPV-100A
Working fluid	Water, sludge, powder, non-corrosive fluids (refer to page 36 in the Introduction for details.)					
Connection	25 flange	40 flange	50 flange	65 flange	80 flange	100 flange
Port size mm	25	40	50	65	80	100
Cv flow factor	35	90	200	350	490	620
Withstanding pressure MPa	1.0					
Working pressure range MPa	0.05 to 0.5					
Fluid temperature °C	5 to 60					

## How to order

HPV - (25A) - T

A Port size

B Rubber sleeve material

Symbol	Descriptions
<b>A Port size</b>	
25A	25 flange
40A	40 flange
50A	50 flange
65A	65 flange
80A	80 flange
100A	100 flange
<b>B Rubber sleeve material</b>	
T	Natural rubber
N	Chloroprene rubber

## Internal structure and parts list

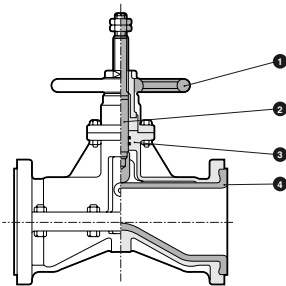

## Dimensions

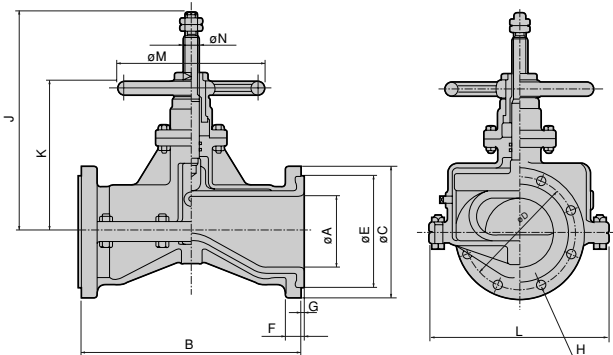

No.	Parts name	Material	Flange								J	K	L	M	N		
			A	B	C	D	E	F	G	H							
1	Handle	FC250	Cast iron														
2	Stem	SUS403	Stainless steel														
3	Body	FC250	Cast iron														
4	Sleeve	Natural rubber or chloroprene rubber															
				Model no.	A	B	C	D	E	F	G	H	J	K	L	M	N
				HPV-25A	25	149	125	90	70	16	3	4-ø19	202	139	126	160	18
				HPV-40A	40	184	140	105	85	18	3	4-ø19	249	168	167	180	20
				HPV-50A	50	211	155	120	100	18	4.5	4-ø19	269	181	203	180	20
				HPV-65A	65	260	175	140	120	18	5	4-ø19	324	210	234	200	22
				HPV-80A	80	289	185	150	130	18	5.5	8-ø19	363	240	261	224	24
				HPV-100A	100	338	210	175	155	20	6	8-ø19	421	272	294	280	28